

BOSS HYDRAULICS LLP

An ISO 9001:2015 Company

Since Year 2000..

Celebrating
25 Years



BOSS
HYDRAULICS LLP

Hydraulic Gear Pumps

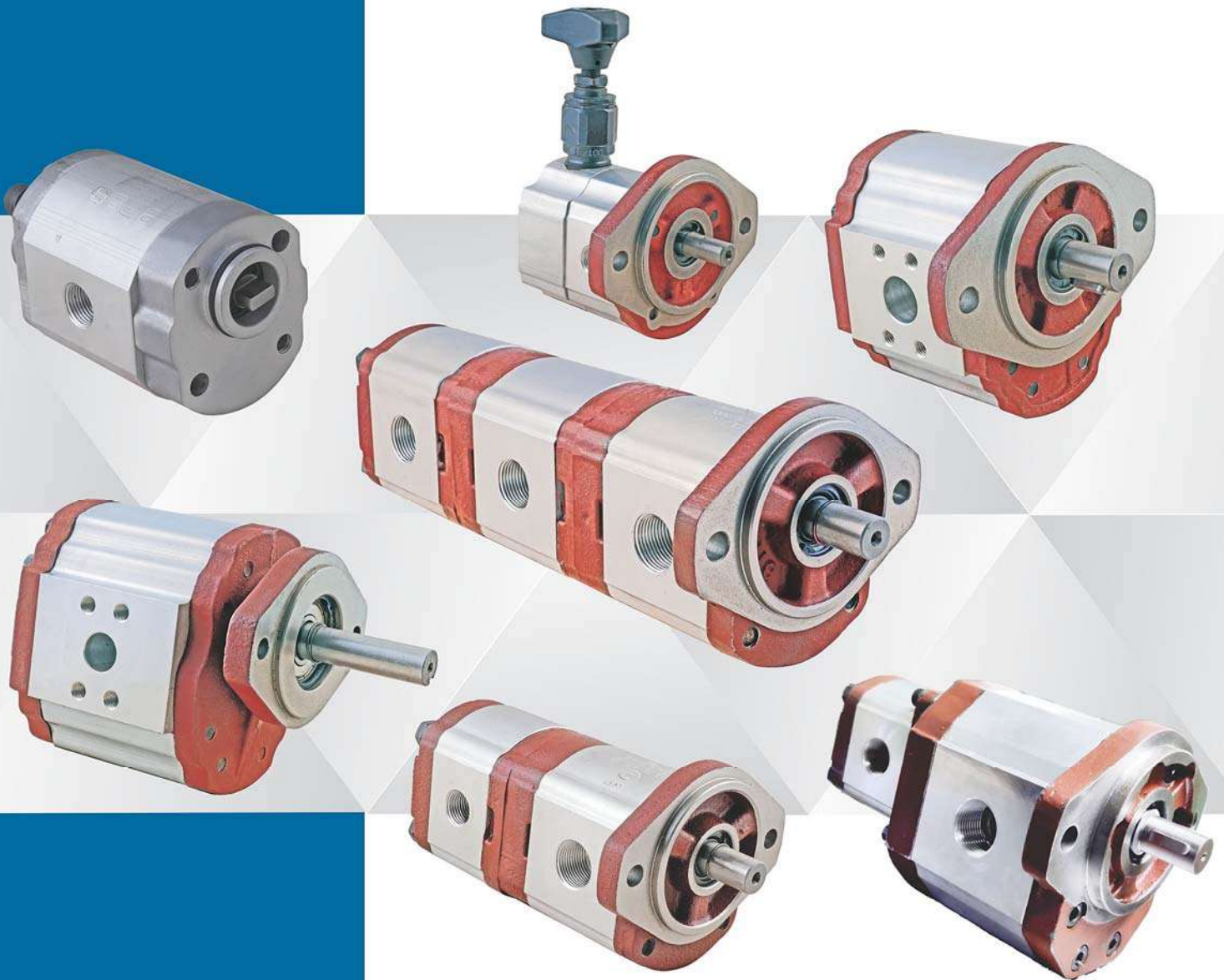

Quality Brands
INDIA



Award for Quality Winner
2018 - 2019



Member:

EPCINDIA
ENGINEERING THE FUTURE



PROFILE



BOSS Hydraulics LLP is an ISO 9001:2015 Certified Company. We produce Hydraulic Gear Pumps with Aluminium extrusion housing and Hand Pump under the brand name of **BOSS** SINCE THE YEAR 2000...

BOSS Hydraulics LLP has Customer across the globe BOSS HYDRAULICS LLP, having state-of-the-art manufacturing facilities, incorporates the largest process technologies, It is able to meet varied customer needs with range of over 100 different types of hydraulic pumps with displacement ranging from 0.8 cc to 67 cc with maximum pressure of 250 Bar.

Boss Hydraulics LLP export under the Brand of **Merbok**® to more than 33+ countries across the globe including USA, RUSSIA, UK, ITALY, FRANCE, POLAND, GERMANY, ROMANIA, SLOVAKIA, SLOVENIA, EGYPT, MALAYSIA, VIETNAM, REPUBLIC OF BELARUS, UAE, AND MORE.....



GLOBAL PRESENCE



www.merbok.in



Mr. RENISH BHASKAR
FOUNDER & CEO

Having 26 Years of Experience in Hydraulics Industry in India and abroad, in Manufacturing, Product Development, Marketing. Wide experience in export marketing and has Visited more than 25 Countries across the globe. Has been always accepting and implementing technologies for Indian market.



Mr. V. Chandra Mohan Reddy
Manufacturing Process Advisor

Over 33 years of experience in manufacturing, new product development, service, and tooling. Led three hydraulic manufacturing units, boosting productivity 4X and implementing automation with lean manufacturing. Key liaison for major customers, ensuring effective communication. Experience spans automotive, tool manufacturing, and hydraulics industries.



Mr. SANJAY PRAJAPATI
QC MANAGER

Having 15 Years experience in quality control automotive tier-1 industrial. Wide experience in implementation of IATF16949 in automobile industries and having experience in critical parts of manufacturing.



Mr. HARIKRUSHNA PATEL
AGM COMMERCIAL

Law graduate (LLB) - taxation -25 years of experience in accounting and finance field. Specialized in taxation and legal matters. Also having hold in banking finance, commercial, export, import and company laws.



Mr. E P MANI NAIR
VP Sales & Marketing

Having 35 Years of Experience in the field of Industrial and Mobile hydraulics in Marketing, Manufacturing and commissioning of systems at plants and equipment. Working since last 8 years in the field of construction machine industry. Recently, has stepped foot in tractor implements and successfully moving forward



Mr. RAHUL PATHAK
Manager Business Development

Having progressive experience at BOSS Hydraulics LLP, starting the journey (2015) in the Accounts Department. Later transitioned to the Sales Department, beginning as a Sales Coordinator and gradually rising to the role of Manager Business Development. With a blend of accounts knowledge, sales experience, and interpersonal skills, actively managing: Coordination with Sales Executives, customer & sales team..



Ms. MONIKA MODI
Manager Sales & Marketing

Started the journey in 2019 at BHL as an Executive in Media Marketing, gradually transitioning into OEM Sales & Marketing. With dedication and consistent performance, progressed to the role of Manager Sales & Marketing.



MS. KOMAL BOKADE
International Sales Manager

Started with BOSS Hydraulics LLP in 2020 as Export Executive, building pathways into new markets with determination and insight. Today, as International Sales Manager, leads the charge in connecting BOSS Hydraulics LLP to the world "cultivating partnerships, unlocking opportunities, and shaping strategies that deliver results across borders.



« DESIGN

BHL has Designing with 3D Software Solidworks 2020 for Modelling and Drafting.

QUALITY »

- Quality with Precise Measurement (0.00001mm) with CMM make Accurate Spectra, using PH20 5-Axis Infinite Indexing Touch Trigger system. Measuring Range: X - 600 mm, Y - 1000 mm, Z - 500 mm.
- Digital Height Gauge with (0.001mm) measurement, make Trimos from Switzerland. Measuring Range 400 mm.
- Surface value measurement with Roughness Tester make- mitutoyo.



« VMC SHOP

HAAS (USA) make machine with Rotary table 360 (4 Axis). ACE Micromatic make machine with Pallet Changer.

CNC ANGULAR GRINDING »

3 Axis CNC Cylindrical Angular Grinding Machine, with in process width control and OD Control Gauge from MARPOSS (Italy).



« CNC SHOP

BHL has equipped with CNC Lathes which and ACE Micromatic India Producing all major components in-house machining.



TESTING FACILITIES

BHL is equipped with a zero human interference automatic testing benches, capable of testing under variable RPM, temperature, and pressure bar.

GROUP OOP PUMP TECHNICAL DATA

Pump type	Nominal Delivery lpm @ 1500 rpm	Max. Working Pressure (P1) in Bar	Max Speed rpm	Ports	
				Suction	Delivery
P-50	7.5	200	3000	G 1/2"	G 3/8"
P-75	11.25	200	3000	G 1/2"	G 1/2"



GROUP OP TECHNICAL DATA



Pump type	Nominal Delivery lpm @ 1500 rpm	Max. Working Pressure (P1) in Bar	Max Speed rpm	Ports	
				Suction	Delivery
6003	1.2	200	3000	G 3/8"	G 3/8"
6004	1.8	200	3000		
6006	2.5	200	3000		
6008	3.4	200	3000		
6011	4.8	200	3000		
6013	5.8	200	3000	G 1/2"	G 1/2"
6015	6.8	200	3000		

GROUP 1P TECHNICAL DATA

Pump type	Nominal Delivery lpm @ 1500 rpm	Max. Working Pressure (P1) in Bar	Max Speed rpm	Ports	
				Suction	Delivery
BHP14	6.8	250	3500	G 1/2"	G 1/2"
BHP17	8.0	250	3500		
BHP20	9.5	250	3500		
BHP28	13.1	250	3500		
BHP36	16.6	250	3500		
BHP44	20.5	250	3000	G 3/4"	G 3/4"
BHP52	24.0	250	3000		
BHP60	27.7	230	3000		
BHP72	33.0	210	3000		
BHP90	41.0	180	2500		



Technical specification are approximate values and subject to change without notice.
Note: All The Values shown for reference purpose only

GROUP 2P PUMP TECHNICAL DATA

Pump type	Nominal Delivery lpm @ 1500 rpm	Max. Working Pressure (P1) in Bar	Max Speed rpm	Ports	
				Suction	Delivery
6050	23.0	200	2900	3/8" -16 UNC (x4) 1" BSP Thread	3/8" -16 UNC (x4) 3/4" BSP Thread
6070	32.0	200	2900		
6090	41.0	200	2900		
6105	48.0	200	2900		
6120	54.5	200	2900		
6146	66.5	170	2500		
6158	72.0	170	2500		
6185	84.0	150	2400		
6220	100.0	130	2400		



ALPHA PUMP TECHNICAL DATA



MODEL NO.	Nominal Delivery lpm @ 1500 rpm	Max. Working Pressure (P1) in Bar	Max Speed rpm	Ports	
				Suction	Delivery
BGP 23	23.0	180	2900	G-1"	G-3/4"
BGP 32	32.0	180	2900		
BGP 41	41.0	180	2900		
BGP 48	48.0	180	2900		
BGP 54	54.5	180	2900		
BGP 66	66.5	150	2500		
BGP 72	72.0	150	2500		
BGP 84	84.0	150	2400		
BGP 100	100.0	100	2400		
				G-1-1/2"	G-1"

GROUP G3 PUMP TECHNICAL DATA

Model No.	Nominal Delivery lpm @ 1500 rpm	Max. Working Pressure (P1) in Bar	Max Speed rpm	Ports	
				Suction	Delivery
G320	28.0	250	3000	G 3/4"	G 3/4"
G322	31.0	250	3000		
G325	36.0	250	3000		
G328	40.0	250	3000		
G332	46.0	250	3000		
G336	51.0	250	2800		
G342	60.0	230	2500		
G346	66.0	230	2300		
G350	72.0	200	2100		
G355	79.0	200	1750		
G360	86.0	180	1750		
				G 1-1/4"	



Technical specification are approximate values and subject to change without notice.
Note: All The Values shown for reference purpose only

TANDEM PUMPS

WE ARE MANUFACTURE TANDEM PUMPS WITH 'OLDHAM COUPLING' CONNECTION.

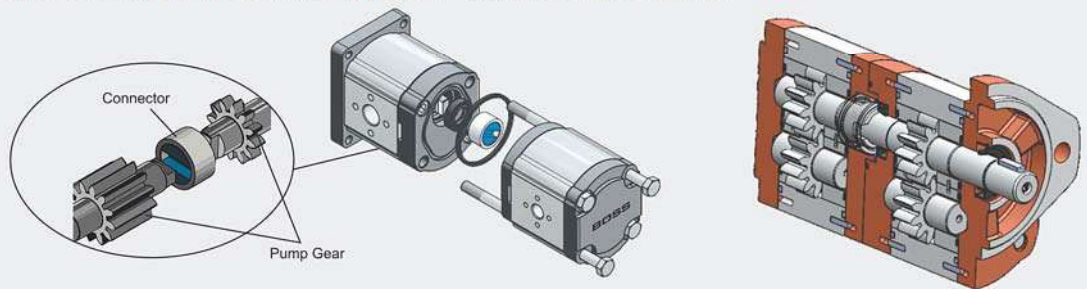

GROUP - 0P - 0P »

PUMPS are available in SAE 2 & 4 bolt flang with Parallel shafts.
Displacements: 2.4 lpm to 14 lpm. Maximum Pressure @ **200 bar**



« GROUP - 1P - 1P

BHP+BHP series has developed for **HIGH PRESSURE APPLICATION**, which can use up to **230 bar** maximum pressure. Pumps are available in SAE 2 bolt & 4 bolt flanges with parallel, spline & taper shafts.
Displacement: 14 lpm to 82 lpm. Maximum pressure @ **230 bar**.

GROUP - 1P - 1P - 1P »

BHP+BHP+BHP series has developed for **HIGH PRESSURE APPLICATION**, which can use up to **230 bar** maximum pressure. Pumps are available in SAE 2 bolt & 4 bolt flanges with parallel, spline & taper shafts.
Displacement: 27 lpm to 123 lpm. Maximum pressure @ **230 bar**.



« GROUP - 1P - 0P

PUMPS are available in SAE 2 bolt & 4 bolt flanges with parallel, spline & shafts.
Displacements: 8 lpm to 48lpm. Maximum Pressure @ **200 bar**

GROUP - 2P - 1P »

PUMPS are available in SAE 2 bolt & 4 bolt flanges with parallel, spline and tapers shafts.
Displacements:30 lpm to 140 lpm. Maximum Pressure @ **200 bar**



« GROUP - 2P - 2P

PUMPS are available in SAE 2 bolt & 4 bolt flanges with parallel, spline and tapers shafts.
Displacements:45 lpm to 200 lpm. Maximum Pressure @ **200 bar**

GROUP - G3 + G3 »

PUMPS are available in SAE 2 bolt & 4 bolt flanges with parallel, spline and tapers shafts.
Displacements:56 lpm to 170 lpm. Maximum Pressure @ **250 bar**

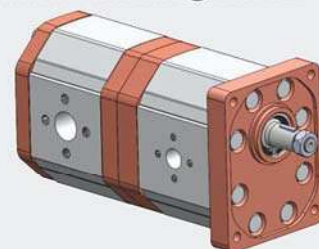

« GROUP - G3 + 1P

PUMPS are available in SAE 2 bolt & 4 bolt flanges with parallel, spline and tapers shafts.
Displacements:35 lpm to 125 lpm. Maximum Pressure @ **250 bar**

SPECIAL APPLICATION PUMPS



HAND PUMP



**Manual Pumps for single acting cylinder.
Displacement 14 cc with working pressure 200 bar.**

Pumps shown above represent a small portion of our Product Range. Ask for our Product list or visit our Website. We reserve the right to technical modifications. The above products shown only for reference.



Reg. Office / Unit No.1:
C-1/276, Phase 1, G.I.D.C., Naroda,
Ahmedabad - 382 330. Gujarat, India.
Tel.: +91-79-2280 0836 / 38 / 39
E-mail : enquiry@bossgroup.co.in
sales@bossgroup.co.in

Sales Contact:
+91 95101 99873



www.bosshydraulics.com